

Berkeley's PATHS

Dedicated to the preservation and restoration of public paths, steps and walkways in Berkeley for the use and enjoyment of all.

Berkeley Path Wanderers Association is a grassroots volunteer group of community members who have come together to increase public awareness of the City of Berkeley's pathways.

BPWA hopes to accomplish this goal through volunteer-led path walks; identification and accurate mapping of Berkeley's complete path network; and eventual restoration of paths that have been blocked or obscured. We hope the final outcome of the community effort will be the preservation and on-going maintenance of all the paths, lanes and steps throughout Berkeley.

Join Us at the First Annual Potluck!

**May 8 noon - 3:00, picnic area #2
Live Oak Park, near the Art Center**

Bring a delicious dish or drink as well as any stories and dreams you have about the paths, and pictures which you would like to share. And come relax in the park with those interested in the paths of Berkeley.

Upcoming Meetings

General Meetings

7-9 pm Live Oak Park Recreation Center

September 16th

Panoramic Way talk, by Ron Sires.

Solano Stroll and How Berkeley Can You Be

November 18th

A Newsletter of the Berkeley Path Wanderers Association, Spring 1999 Vol. 2 No. 2

Remembering the Marin Circle Fountain & Fountain Walk Restoration

Gail Keleman, Linda Perry and Emily Sorter gave an inspirational history on their efforts to restore Fountain Walk and the Marin Circle Fountain at our last BPWA meeting. Beginning with stone post-hugging, they expanded their efforts by organizing workgroups to uncover the beautiful balustrades along Fountain Walk, which had been buried under masses of bamboo, ivy, bottles, years of unde-

livered newspapers and generic litter. They made daily calls to city officials and joined forces with a competing committee, eventually forging a coalition. They also bravely launched a fundraising campaign in the neighborhood, an effort which lasted four years and involved 1200 donors.

"Neighbors design their public spaces & then public spaces design the people."

Jerry Tierney, Berkeley architect



Northbrae was Mason McDuffie's second planned community. The layout of its meandering roads, following the contours of the land, reflected the influence of Bernard Maybeck, with whom Duncan McDuffie studied at UC Berkeley. At McDuffie's suggestion architect John Galen Howard was hired and artistic elements were added such as street names on stone posts; neighborhood parks; sidewalk lawns, flowers and trees; and of course the fountain — according to campaign literature of the time, three others were promised.

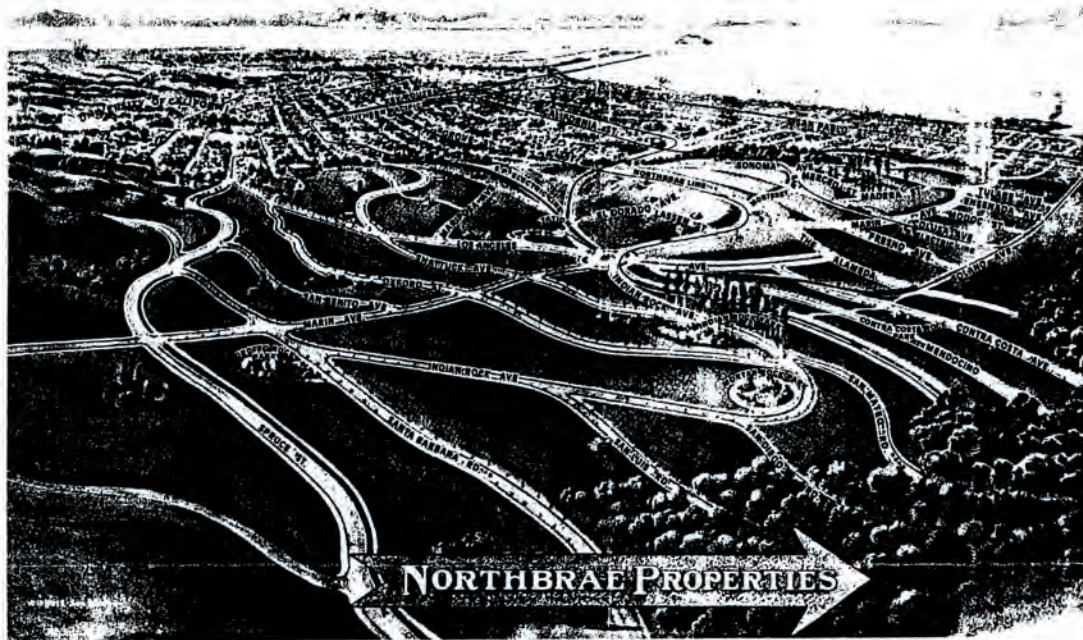

Fountain Restoration *continued from front*

The original fountain stood for 50 years at Marin Circle until it was knocked down in an accident in the late 50s, (some say a roofing company truck knocked into the fountain, some say a teenage girl in her parent's Cadillac lost control, smashing into the fountain — there are 15 stories at least as to how the fountain was damaged). Designed in 1910 by famous architect, John Galen Howard, and featuring bear cub sculptures by Arthur Putnam, the fountain was Berkeley's first public work of art and the centerpiece of the Northbrae

neighborhood. The fountain was part of Howard's urban plan for the area which included a hub of seven streets, a grand pedestrian walkway from the circle to the Solano Tunnel below, a classical balustrade surrounding the circle and terra cotta planters.

The dedication for the restored fountain and walk took place September 15 1996, a gift to the city from the organizers who worked so hard and all the generous neighbors who contributed money. \$117,000 was raised which bought a project worth over \$200,000.

Updates

Path Upkeep

Adopt-A-Path

In the interest of maintaining and improving the various 135+ public paths in Berkeley, we've introduced an "Adopt-a-Path" program whereby path neighbors and BPWA members devote attention to the care of a specific path(s). Each informal group would assess the needs of a path, arrange for the necessary tools and group members, and on occasion conduct a two+ hour work party to clean that path. Tasks would involve weeding, raking, sweeping, litter collection, pruning, and the noting of essential path repairs to be performed by the City.

Prior to any path cleanup, the group coordinator would provide informal written notice to the path's neighbors of the intended cleanup (encouraging their participation as well), insure that the City is contacted before and after the clean-up, and listing needed repairs and improvements.

Anyone interested in helping or adopting a specific path should contact Tom Edwards at 525 4064 or twedwards@juno.com for further information.

Northside Path Has Reopened!

Woodchips have been laid around the native plant restoration areas along Berryman Path's north portion, north of the creek and leading to the Art gallery and to Walnut Street. Take a walk along the creek and see the difference!

Report Missing Signs

Please report newly missing or damaged path signs to Public Works (sign department) at 644-6620. Ask to have a work order to replace the sign prepared.

Report other missing signs to Ruth Moskovitz at 524-0713 so we can check and revise if necessary our path surveys.

Upcoming Path Walks

Saturdays at 10:00 am

May 22 Northbrae Paths & Rock Parks
Pat De Vito, leader 527-2693
Meet at Spruce & Santa Barbara

June 5 Aquatic Park (level Paths)
Mark Lollo, leader 549-0818
Meet at Channing Street parking lot

July 24 Ohlone Greenway & Codornices Creek
Susan Schwartz, leader 848-9358
Meet at north side of North Berkeley BART

August 7 Solano to Tilden
Janet Byron, leader 848-4008
Meet at Peet's on Solano Avenue

September 25 North Berkeley Paths
Erika St. John, leader 548-0129
Meet at Keith & Shasta

October (date to come) Waterfront—
Existing & Future Bay Trail (level Paths)
Susan Schwartz, leader 848-9358
Details to come

Volunteers Needed

If you would like to lead a walk for the month of November or December, 1999 please call Jacque at 524-4715.